

TEHNIC MB 86 EI

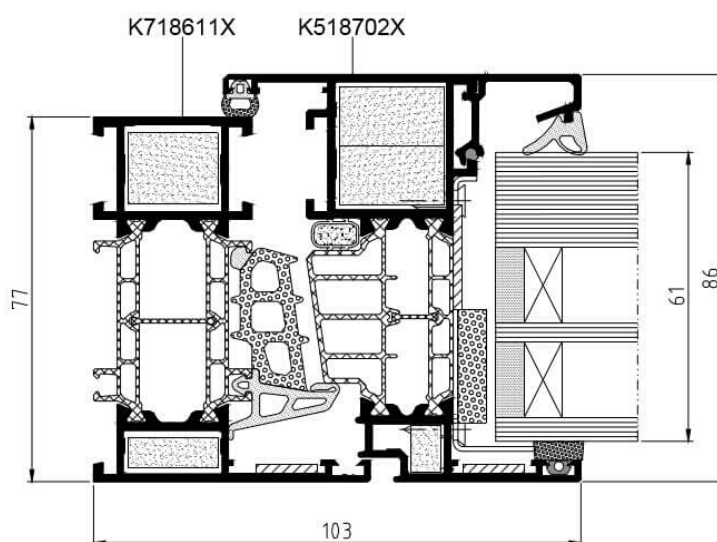
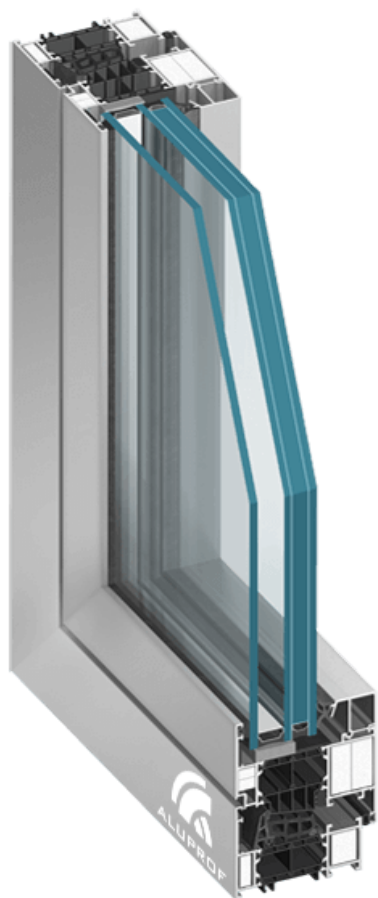

MB-86EI is used for fabrication of EI30 fire-rated openable windows to EN 13501- 2+A1. MB-86EI is based on MB-86 system, and has excellent thermal, sound reduction, water resistance and air leakage performances.

INNOVATIVE TECHNOLOGY

The MB-86EI combines the advantages of a classic window system with the properties of a fire partition walling – the construction meets all the requirements of the applicable regulations and standards, especially regarding energy saving and environmental protection, while ensuring proper fire safety.

The system is classified as non-fire spreading (NRO)

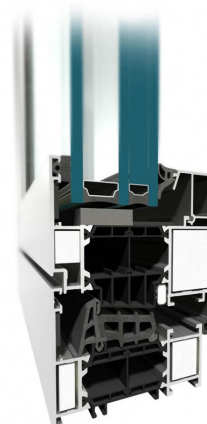

FEATURES AND AESTHETICS

- three-chambered profiles, with a 43 or 42 mm-wide insulation chamber between thermal breaks as a central part
- fire resistance is ensured by the appropriately rated glass panes, fire insulation elements in the internal chambers of aluminium profiles and special accessories and materials used in the space between aluminium profiles and the glazing
- wide range of glazing thickness allows for use of different types of insulated glass, including triple glazing units
- hardware used in MB-86EI is typically RC2 burglar-resistant-rated

TECHNICAL SPECIFICATION	MB-86EI
Depth of frame	77 mm
Depth of casement	86 mm
Glazing thickness	frame: 13 - 61 mm casement: 22 - 70 mm

SIZE AND WEIGHT LIMITATIONS	
Maximum casement size (H×L)	H to 2400 mm L to 1300 mm
Max casement weight	130 kg

PERFORMANCE	MB-86EI
Air tightness	class 4, PN-EN 12207:2001
Watertightness	class E1500, PN-EN 12208:2001
Thermal insulation U_w	from 0.86 W/(m ² K)
Fire resistance	class EI30



920095, Șos. Călărași, km 93
Mun. Slobozia, Jud. Ialomița
România | Hamilton Business
Center, corp 5

QUALITY DRIVEN