

PASIV HOUSE MILLENNIUM PLUS 80 DOOR

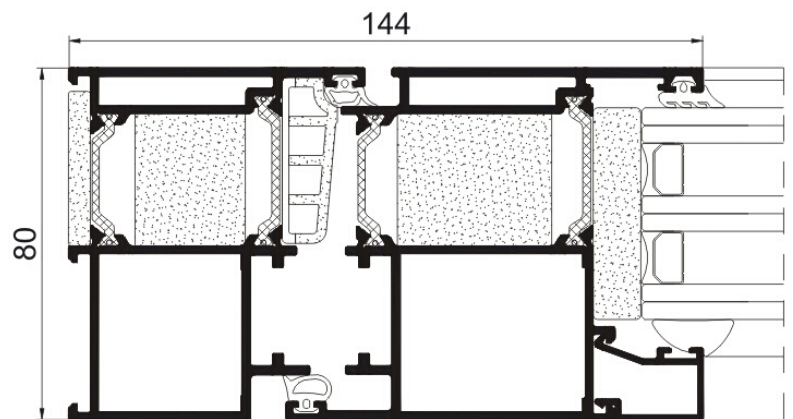

ENERGY EFFICIENCY

Thermal Transmission Coefficient

U_w from 0.8 (W/m²K)

Please consult typology, dimensions and glazing.

ACOUSTIC INSULATION

Maximum glazing: 64 mm

Maximum acoustic insulation: $R_w = 40$ dB

CATEGORIES ACHIEVED AT TEST CENTRE

Protection against atmospheric agents

Air permeability (UNE-EN 12207:2000): Class 4

Water tightness (UNE-EN 12208:2000): Class 6A

Wind resistance (UNE-EN 12210:2000): Class C4

Reference test window 1.18 x 1.18 m 2 Sashes

Resistance to soft body impact (UNE-EN 13049:2003): Class 5 (max)

Reference test door 1.80 x 2.20 m 2 sashes. Laminated glazing 3+3

Resistance to repeated opening and closing (UNE-EN 1191:2000): 500,000 cycles

Reference test door 0.935 x 2.10 m 1 Sash

PASIV HOUSE MILLENNIUM PLUS 80 DOOR

SECTIONS	Frame 80 mm Sash 80 mm
PROFILE THICKNESS	Door 2.0 mm
MAXIMUM DIMENSIONS	Width (L) = 1,800 mm Height (H) = 3,000 mm <i>Door</i> Width (L) = 1,500 mm Height (H) = 2,700 mm <i>Concealed-hinge-door</i>
MAXIMUM WEIGHT/SASH	220 Kg 120 Kg (concealed hinges)

Please consult maximum dimensions according to types

FINISHES	Colour powder coating (RAL, mottled, rough...) According to Qualicoat >60 microns Wood effect powder coating According to Qualideco standard Anodized According to Ewwa Euras Standard Class 15 Optionally Class 20 and 25 Optionally bicoloured
HARDWARE	Optionally concealed hinges Optionally security hardware

EXTRUSION ALLOY	6063 T-5
POLYAMIDE STRIP LENGTH	Polyamide 6.6 reinforced with 25% fiberglass: 34 mm
GASKETS	EPDM double gasket
FOAMS	Perimeter polyolefin foam in glazing rebate zone
OPENING POSSIBILITIES	
INWARDS	Side hung 1 and 2 sashes
OUTWARDS	Side hung 1 and 2 sashes
AUTOM.	Inwards and outwards side hung 1 sash

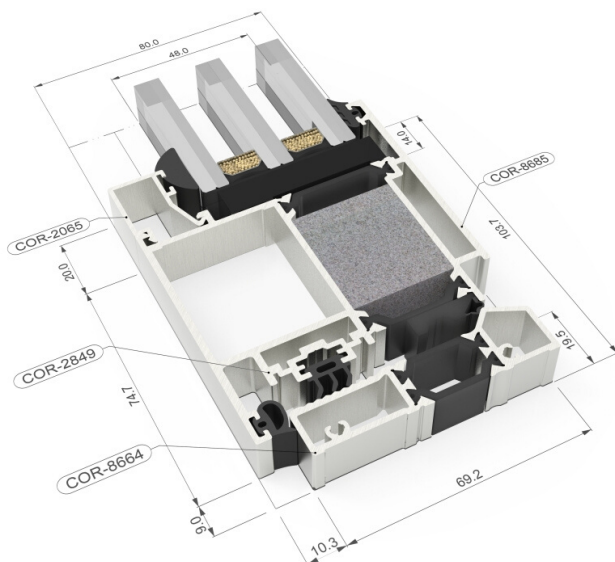

920095, Șos. Călărași, km 93
Mun. Slobozia, Jud. Ialomița
România | Hamilton Business
Center, corp 5

QUALITY DRIVEN