

STANDARD COR 4500 LIFT & SLIDE

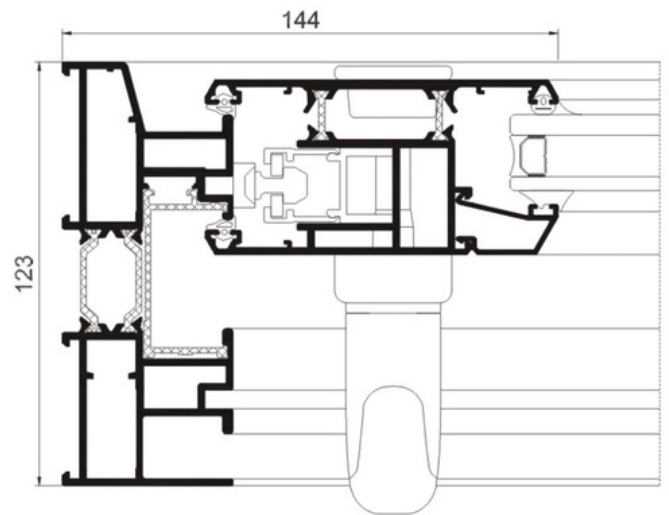

ENERGY EFFICIENCY

Thermal Transmission Coefficient

U_w from 1.5 (W/m^2K)

Please consult typology, dimensions and glazing.

ACOUSTIC INSULATION

Maximum glazing: 38 mm

Maximum acoustic insulation: $R_w = 42$ dB

CATEGORIES ACHIEVED AT TEST CENTRE

Protection against atmospheric agents

Air permeability (UNE-EN 12207:2000): Class 4*

Water tightness (UNE-EN 12208:2000): Class 8A*

Wind resistance (UNE-EN 12210:2000): Class C4**

*Reference test 2.62 x 2.5 m 2 Sashes

** Reference test 1.85 x 2.05 1 Sash + 1 fixed

STANDARD COR 4500 LIFT & SLIDE

SECTIONS	Frame 100/123/127 mm Three-rail 185 mm Sash 51 mm
PROFILE THICKNESS	Door 2.0 mm
MAXIMUM DIMENSIONS	Width (L) = 3,000 mm Height (H) = 3,300 mm <i>Lift&Slide version</i> Width (L) = 2,500 mm Height (H) = 2,600 mm <i>Sliding version</i>
MAXIMUM WEIGHT/SASH	400 Kg Lift & Slide 280 Kg Sliding

Please consult maximum dimensions according to types

EXTRUSION ALLOY
6063 T-5
POLYAMIDE STRIP LENGTH
Polyamide 6.6 reinforced with 25% fiberglass: Lift&Slide version: 24 and 14,6 mm Sliding version: 30 and 14,6 mm
OPENING POSSIBILITIES
Sliding 2, 3, 4 and 6 sashes. Optionally monorail and three-rail (1 sash + 1 fixed) (2 sashes + 1 fixed) Optionally corners in 90° without profiles. Galandage 1 and 2 sashes

FINISHES	<p>Colour powder coating (RAL, mottled, rough...) According to Qualicoat >60 microns</p> <p>Wood effect powder coating According to Qualideco standard</p> <p>Anodized According to Ewva Euras Standard Class 15 Optionally Class 20 and 25 Optionally bicoloured</p>
----------	--

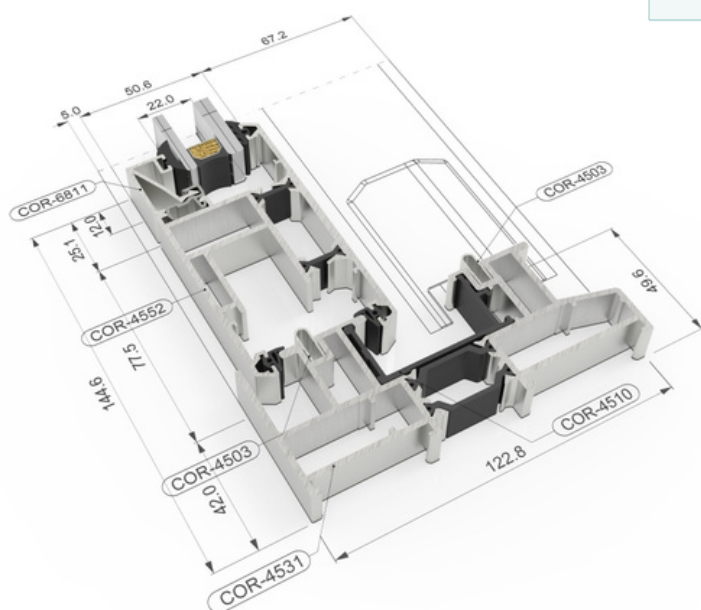

TECHLINE
PROJECT DESIGN

Str. Păsărilor nr. 2
Moara Vlasiei, Ilfov
office@techline.ro
+40 767 444 000